



Your Solutions Partner

DUKE MANUFACTURING CO.
2305 N. Broadway
St. Louis, MO 63102
800.735.3853 Toll Free 314.231.5074 Fax
www.dukemfg.com

MODEL:
38" Production Center - Dual Sided



DPC38D-K

BODY:

- 4" Locking Casters
- Lower wrap shelf for product packaging and dry storage (Located on both sides)
- Extra deep work surface carving board area with crumb guard
- Stainless steel overshelf

UNDERCOUNTER REFRIGERATION:

- (2) Fully extendable refrigerated drawers allow easy pan access. Capacity = (12) 1/6 x 6" Deep Pans Each. (Accommodates Full, 1/2, 1/3 and 1/6 pans)
- Digital thermostat

COLD PAN:

- Counter top cold pan capacity (15) 1/6 x 6" deep pans

ACCESSORIES (Optional):

- Removable bottle holder capacity (12) bottles total
- Pull-out crumb collection pan



DPC38D-K
(shown with
optional
accessories)



NEMA 5-15 Receptacle

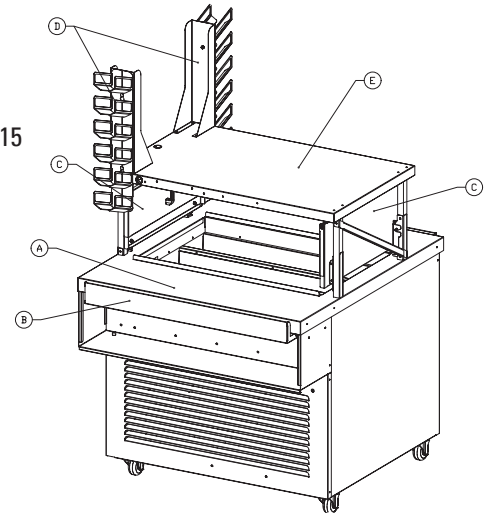

DIMENSIONS:

Model	Height	Width	Depth	Volts	Amps	Shipping Weight
DPC38D-K	34-5/8"	38-1/4"	44-3/8"	115	10.4	565 lbs

- A. EXTRA DEEP WORK SURFACE CARVING BOARD AREA AND CRUMB GUARD
- B. PULL-OUT CRUMB COLLECTION PANS (OPTIONAL)
- C. STAY-IN-PLACE FOLD UP COLD PAN COVERS (COMES STANDARD)
- D. REMOVABLE BOTTLE HOLDERS CAPACITY (12) BOTTLES TOTAL (OPTIONAL)
- E. OVERSHELF

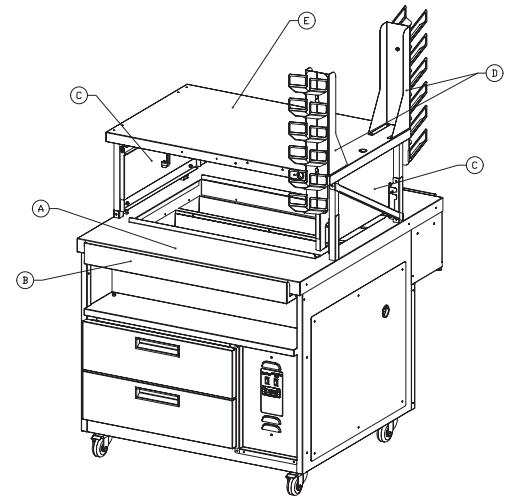
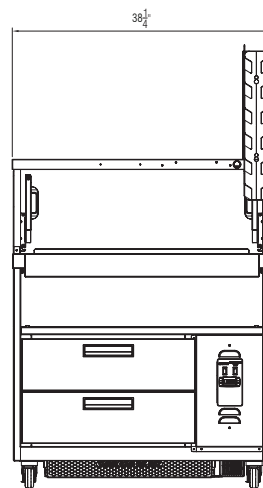
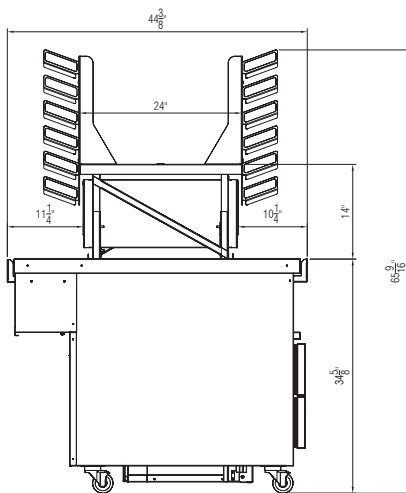

AGENCY LISTINGS:

Specification subject to change

